

HEX SWAGE STANDOFFS

3/16 150

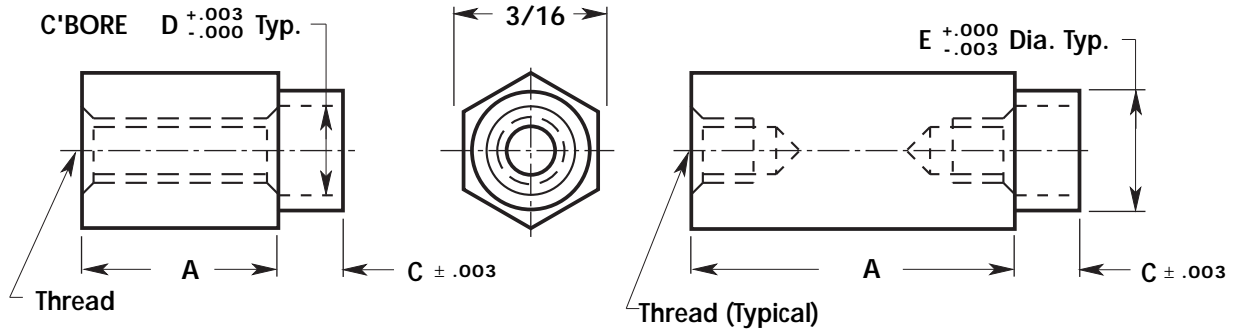

DEPTH OF THREADS TAPPED THRU			
THREAD	ALUM • BRASS NYLON • STEEL	STAINLESS STEEL	SCREW DEPTH
2-56	3/4	1/4	3/16
3-48	3/4	5/8	3/16

BASIC NO.	PART NO.	A LENGTH	C'BORE D	DIA E
150	01	1/8	.108	.139
150	02	3/16	.108	.139
150	03	1/4	.108	.139
150	04	5/16	.108	.139
150	05	3/8	.108	.139
150	06	7/16	.108	.139
150	07	1/2	.108	.139
150	08	9/16	.108	.139
150	09	5/8	.108	.139
150	10	11/16	.108	.139
150	11	3/4	.108	.139
150	12	13/16	.108	.139
150	13	7/8	.108	.139
150	14	15/16	.108	.139
150	15	1"	.108	.139

SWAGE LENGTH C ± .003	CODE	BOARD THICKNESS
.075	1	1/32
.105	2	1/16
.135	3	3/32
.165	4	1/8
.230	5	3/16
.290	6	1/4

MATERIAL	CODE
Aluminum	AL
Brass	BR
Stainless Steel	SS
Steel	ST

ORDERING INFORMATION				
XXX-XX	XX	XXX	X	X
Basic No & Part No	Material	Thd.	C	Finish
Example				
150-10	BR	348	2	*
* For Finish Code See Fold-Out Inside Back Cover				